

2 Megapixel / H.264 / IR

- 2 Megapixel 1/3" CMOS Sensor in High Resolution
- H.264/MJPEG Dual Codec & Streaming simultaneously
- Up to UXGA (1600x1200@15fps) / WXGA (1280x720@30fps)
- Digital I/O for External Sensor and Alarm
- Mechanical ICR
- Built-in IR Illuminator
- 3D Noise Reduction
- 2 Way Audio Support
- 3GPP Support
- IP67 Weather-proof
- PoE Power Over Ethernet IEEE802.3af (Option)



Specifications

Camera		Processors and Memory	
Sensor	2 Mega Pixel 1/3" CMOS sensor	CPU	ARM9 SOC
Scan Method	Progressive	Flash and Memory	16MB NOR flash, 256MB DDRII
Lens	6 mm mega pixel Board lens	I/O and Connectors	
Number of Effective Pixel (H*V)	1600x1200	Alarm I/O	1x Alarm-in, 1x Alarm-out
Minimum Illumination	0.1Lux (AT 30 IRE F1.4 Lens) / 0 Lux (IR on)	LAN	1x RJ-45 Ethernet connector
SNR(max)	42.3db	Audio	1x Audio Line-in, 1x Audio Line-out
White Balance	Yes	Software	
Gain Control	High/Middle/Low, 3 step selection	Browser	Internet Explorer 6.0 or above
DNR	Yes	Application Software	VMS Application Software
IR Illuminators		OS supported	Microsoft Windows 2000, XP, Vista, Windows 7
Wavelength Range	850nm	Features	
Distance	25M	User Setting	Motion Detection
Day and Night	ICR (Auto control by photo sensor; Manual control by CGI) IR-Cut Filter Removable	Date/ Time Setting	Events
Lifetime	Up to 20,000 hours	Video image control	Triggered Actions
Video		Upload configuration	Blind Detection
Video Compression	H.264 BP, MJPEG dual codec, dual streaming, multiple profiles	Dynamic DNS	Privacy Mask
Video framerate	dual streaming (1280x720/30FPS+640x352/30FPS)	Open API	
Resolution	H.264 : 1600x1200, 640x480/320x240/160x128 1280x720, 640x352/320x176/192x112 MJPEG: 1600x1200, 640x480/320x240 1280x720, 640x352/320x176	CGI commands to control camera Media SDK to handle streaming	
Bitrate control	Both CBR and VBR, 128kbps ~ 4Mbps	Factory Default	
Multi-streams	Maximum dual video streams: 1280x720 H.264/30FPS + 640x352 H.264/30FPS + 1280x720 MJPEG/15FPS 1600x1200 H.264/15FPS + 640x480 H.264/15FPS + 1600x1200 MJPEG/15FPS	Manually	
Digital Zoom (PC side)	Yes, 1/2X, 1X, 2X, 4X	Power	
Image Rotation (PC side)	Mirror	Power	DC 12V DC12V/ POE (Option) DC12V/AC24V (Option)
Audio		Power Consumption	3W (IR Off) / 9.6W (IR On)
2 Way Audio	Yes	Physical Properties	
Compression	AMR, G.711 @ 64kbps, G.726 @ 32kbps/ Configure bit rate	Dimensions	250mm(L) x 90mm(W) x 89mm(D)
Network		Weights	1781g
Streaming Protocols	RTSP/RTP/UDP,RTSP/RTP/TCP,RTSP/RTP/HTTP tunneling, LAN Multicast, Multipart-JPEG	Operating environment	
Supported Protocols	IPv4, HTTP, UDP, TCP, ICMP, IGMP, ARP, DHCP, NTP, SMTP, FTP, SAMBA, UPnP, PPPoE, DNS, DDNS, RTSP, RTP, RTCP	Operating temperature	-20°C ~ +50°C
3GPP Mobile Surveillance	Yes	Storage temperature	-30°C ~ +60°C
		Humidity	0% ~ 95% non-condensing
		Certification	
		CE, FCC Class A, RoHS	
		Warranty	
		24 months	



Dimension Diagram

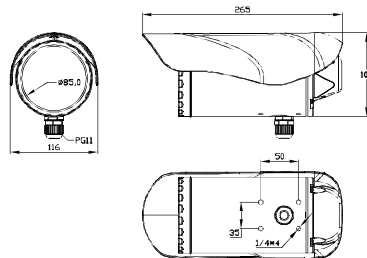

Distributed by:

VISIONxIP
 info@visionxip.com
 www.visionxip.com
 Tel: 5411 3221 0309